

INSTRUCTION MANUAL

Model: ME-203DC 42" DC ceiling fan

READ AND SAVE THESE INSTRUCTIONS

Please read the following instructions carefully and retain a copy of this information for future reference. When using this electrical appliance, the following safety precautions should be strictly followed.

Simple Introduction

1. This product adopts the direct current frequency converted motor that is high efficiency, saving, durable and environmental protection
2. It carries a unique & superior structural design, vague appearance, convenient and time saving installation
3. This product claims at giving you considerate service by unique 5-speed setting, independent light control switch. 1/4/8 timer setting

Caution

1. This product is with input voltage: DC 24v.
2. If you or familiar with electrical installation, be sure have a licensed electrician to install the product for you.
3. Before installing or removing a ceiling fan, you should switch off the power first
4. When installing a ceiling fan, all parts with screws must be tightened firmly.
5. Choose a location for mounting the fan where the blades will be clear from all obstructions and maintain a minimum of 2.3 meters from the floor



Installation preparation tool

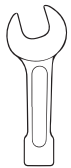

10# Spanner



Slotted screwdriver



Philips screwdriver

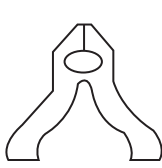

plastic clamp



ladder

Setup Details of parts

- | | | |
|----------------|----------------------|-------------------|
| 1. Cover plate | 4. Screw for blade | 7. Remote control |
| 2. Motor | 5. Downrod with ball | |
| 3. Blade | 6. Bracket | |

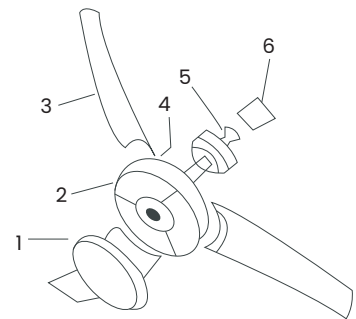

1. Minimum space for Installation (see Fig 1)

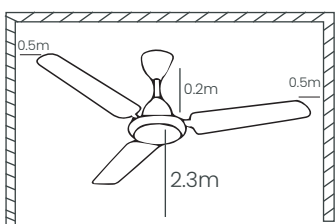

Fig 1

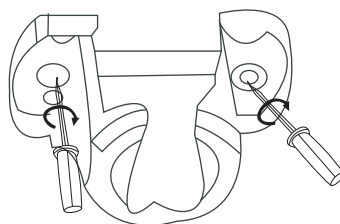

Fig 2

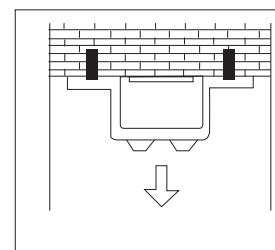

Fig 3

2. Bracket installation

For wooden ceiling, the brackets should be fixed on the beam by 1.5 inches wooden threaded screw! (see Fig 2)

For the cement ceiling, firstly use with 8mm impact drilling bit to drill a hole to fit the expansion screw than secure the bracket on the ceiling by tightening M6 expansion screw see Fig 3)

Note: after the bracket is secured, must ensure the selected ceiling location with the fixings are capable of supporting a minimum weight/gravity of 60 Kgs (use hand try to pull the bracket for safety assurance).

Note, please pay attention to different materials of ceiling and select the appropriate type of screws to fix the bracket. Do not fix the bracket directly on the plywood to avoid screw loosening that causes danger.

3. Blades Installation

1. Insert the fan blades to the motor installation slot. Firm pressure is needed. see Fig 4).

Secure all fan blades using ST<x16 screw by Philips screwdriver until tightened it on the motor cover. Fig 4

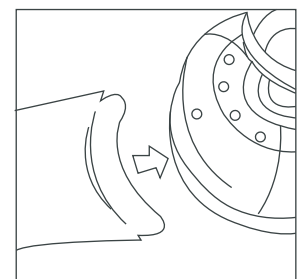

Fig 4



4. Fix the fan to the bracket

Place the calling for to the brocket. Carefully lift the fan and make sure the groove of the ball is locked on the pin from the metal bracet (see fig 6)

5. Wires connection

1. According to the label on terminal block, connect the + polarity wire and -polarity wire. Make sure the secured screws are tightened firmly. Wires should not be loosed. (see fig 7)
2. Slide the upper conopy to the ceiling, lighten the screw. (see figure8)

6. Wall control installation

Align the centre of cover plate on the motor shaft by rotating clockwise until tightened, <see fig 9>

REMOTE CONTROL FUNCTION

1) FAN ON/OFF button

1. switch on/off the fan by pressing this button. You will hear a "Bi "sound, it means the receiver has got your instruction. (You can oso hear a "Bi" sound by pressing each button of remote controller. This notation will not repeat in the following instructions.) 2. The fan is preset at speed 4

2) Light (ON/OFF) button

Switch on and off independently by pressing this button. (It is inapplicable for the fan without lighting)

3) Forward/Reverse(F/R) button-This function is not applicable for this DC fan

4) 1/2/3/4/5(speed button)

1) Speed-1 is the lowest and 2/3/4/5 is gradually increased in air flow. Speed-5 is the highest.

5) 1H/4H/8H

To cycle through these 3 timer settings (1/4/8 hours) by pressing those buttons.

6) Codes detection

This function is designed for two circumstances:

- 1) Within an area of radius 8M where more than 1 ceiling fan installed, able to control them by only one remote control.
- 2) When the controller is out of order, you have to replace a new one.
Code matching steps:
 - a) install batteries into the remote controller
 - b) Make sure the fan is disconnected with power before code matching
 - c) Re-connect the power supply.
 - d) It can run 1 fan or more by using his remote controller.

7) Operating instructions of remote controller installation

- 1) Battery specification of remote controller. A23/12V alkaline battery, other battery specificciors are inapplicable
- 2) Open the cover of battery compartment, identify the polarity of battery and ensure it is in appropriate match: Attention: the polarity must not be wrongly matched. 3) Fix the holder of controller by screw on the wall

Trouble Shooting

Problems	Solutions
Motor cannot work	Ensure the supply cables have been well connected, you should focus on checking the wires connection of the + and - polarity in correct match.
	Identify the polarity of battery in the remote control is in appropriate match. Or check if the battery is too old and dead. Press the remote control, check the indicating light is on.
	Note: if you fail to overcome the above failures, do not make attempt to open the motor cover for repair. You should contact the qualified electrician to fix it
Fan vibration	Ensure the fan-blades have beer firmly secured in place. Ensure the position of each blade be aligned with each other. Ensure the mounting screws are firmly tightened.

Wiring diagram.

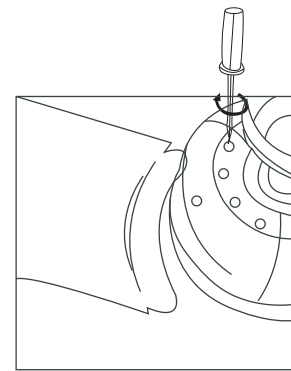
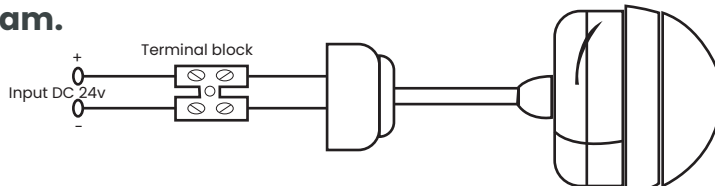

Fig 5

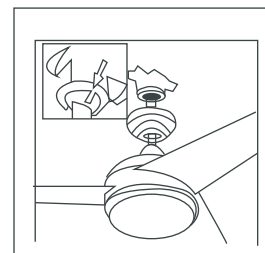

Fig 6

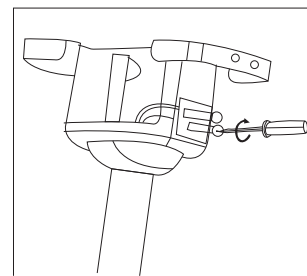
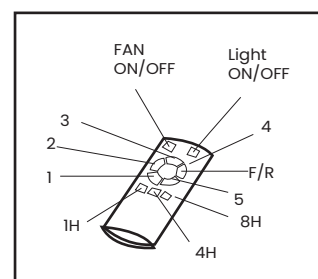

Fig 7

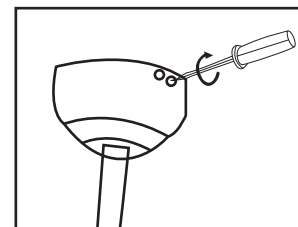

Fig 8

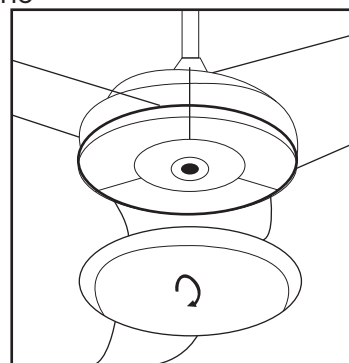

Fig 9

Ref: ME -203DC/20141222

